

TREMproof[®] TWS
Triple Waterproofing System

TREMproof[®] TWS
Triple Waterproofing System



TREMproof[®] TWS is a blindside and underslab triple-layer waterproofing assembly consisting of 20 mils of HDPE, expandable granular bentonite and a protective layer of spun-bonded polyester, coated with 60 dry mils of polymer-enhanced, liquid-applied asphalt membrane.

This durable waterproofing system creates a physical bond to the concrete that eliminates the possibility of lateral water movement between the membrane and the structure. TWS provides superior defense against inclement weather conditions, preventing bentonite hydration prior to concrete placement.

FEATURES AND BENEFITS

- Innovative triple-layer waterproofing assembly, tested per ASTM standards
- Protected bentonite allows for longer exposure to weather and construction elements
- Monolithic asphaltic membrane protects seams and seals penetrations reducing time required for detail work
- Exothermic reaction during concrete cure builds adhesion of the asphaltic membrane to the structure, creating a bonded waterproofing assembly, eliminating the potential for lateral water movement
- Extreme durability with exceptional elongation and crack-bridging characteristics
- Compatible with approved TREMproof, ExoAir and TREMDrain solutions for a continuous building envelope
- Comprehensive on-site technical support and product knowledge expertise
- VOC compliant
- Acceptable for use in hydrostatic conditions*
- Premium waterproofing system backed by an all-inclusive warranty *

*Consult with your local Tremco Sales or Technical Services Representative for more information.

BLINDSIDE WALLS (Cast-in-place and shotcrete)

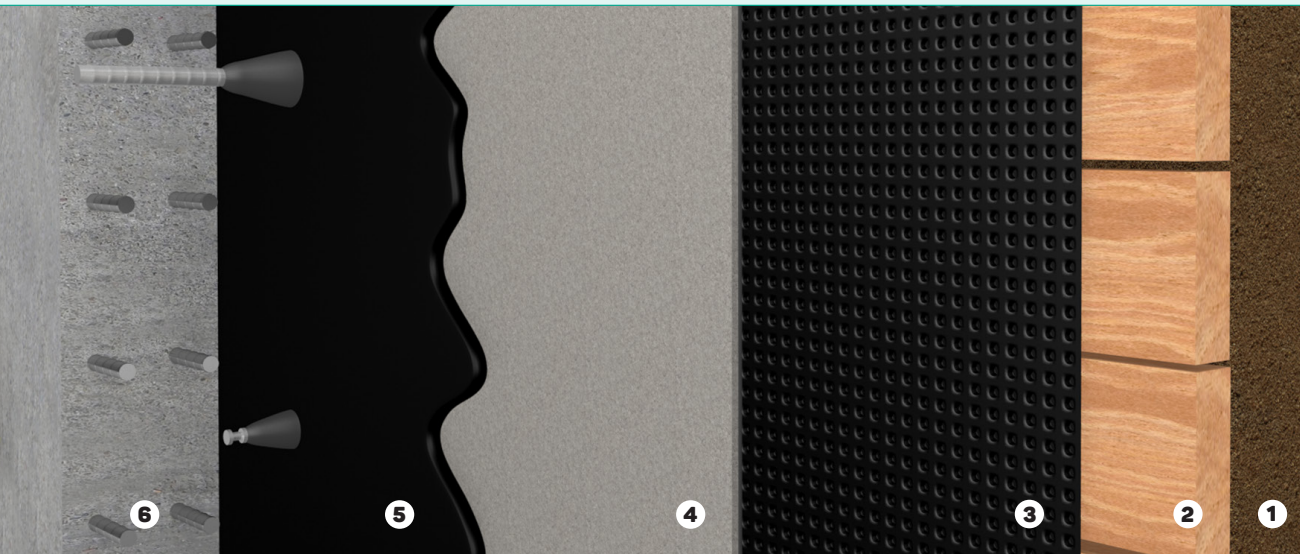

- 1 Retained earth
- 2 Shoring
- 3 TREMDrain system
- 4 Paraseal system
- 5 TREMproof 260
- 6 Shotcrete / concrete

UNDERSLAB / BELOW SLAB ON GRADE

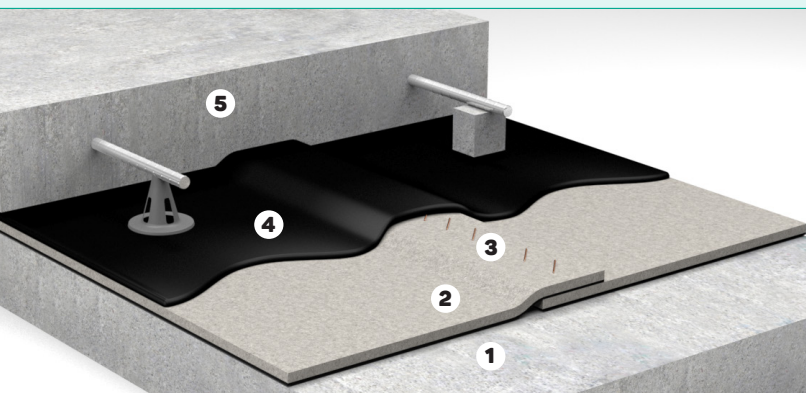

- 1 Concrete or compacted base
- 2 Paraseal system
- 3 Staples
- 4 TREMproof 260
- 5 Concrete

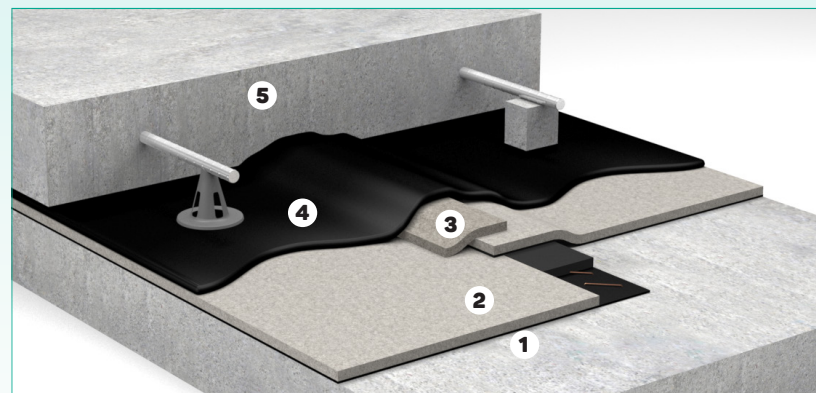

- 1 Concrete or compacted base
- 2 Paraseal system
- 3 Para Stick 'n' Dry
- 4 TREMproof 260
- 5 Concrete